



CONTENTS

<i>Prior to departure</i>	<i>1</i>
1.Before Leaving for Taiwan.....	2
2.Discovering Taiwan.....	4
3.Visa Information.....	5
<i>Arriving in Pingtung</i>	<i>6</i>
1.Transportation.....	7
2.Accommodation.....	12
<i>Introduction of NPTU</i>	<i>18</i>
1.About NPTU	19
2.Goals	19
3.Campus Information.....	20
National Pingtung University Pingshih Campus Plane Configuration Diagram.....	23
National Pingtung University Pingshang Campus Plane Configuration Diagram.....	27
National Pingtung University Minsheng Campus Plane Configuration Diagram.....	30
<i>Life</i>	<i>32</i>
1.Individual account application for post office or bank required documents	33
2.Healthcare and Insurance	33
3.Hospitals and Clinics	34
4.Exchanging for Domestic Driving License	36
5.Life in NPTU	37
<i>Appendix.....</i>	<i>39</i>
1.Emergency Contact Numbers.....	40
2.Highlight Attractions in Greater Pingtung Area.....	40

Prior to departure

- 1. Before Leaving for Taiwan*
- 2. Discovering Taiwan*
- 3. Visa Information*

1. Before Leaving for Taiwan

(1) Documents and other Things You Need to Bring to Taiwan

Checklist of things to bring:

- ☐ NPTU acceptance letter (original copy)
 - ☐ Passport (original and one photocopy)
 - ☐ A valid entrance visa to Taiwan
 - ☐ Plane ticket with set itinerary
 - ☐ Relevant diploma (original and one photocopy)
 - ☐ Two-inch, color head-shot (no hats!) photos, (2 photos)
 - ☐ Six months of valid accident and medical Insurance
 - ☐ Sufficient money to pay living expenses for the duration of your stay (the amount of cash which maybe brought into the country may not exceed that which is specified by law)
- Clothing and personal items (There is a 20 KG limit on check-in luggage and a 7.5 KG limit on Carry-on luggage).
- Articles for daily use (Liquids, such as shampoos and conditioners, may be carried in small amount only. Alternatively, these products can be purchased in Taiwan).
- Medicine (according to one's individual needs)
- For a list of food items which may NOT be brought into the country, see <https://www.baphiq.gov.tw/en/>

(2) Brief Introduction to Taiwan and Pingtung

- Geographical Location - Taiwan is located in the Western Pacific to the southeast of Mainland China, with Japan and the Ryukyu Islands to the North, and the Philippines to the South. Pingtung county is located between Kaohsiung county and Bashi channel and known for its agriculture and tourism.
- Surface Area-Taiwan is about 36,000 square kilometers and Pingtung is about 2776 square kilometers
- Weather - The climate of Taiwan is subtropical. Its summer is hot and humid (25° C to 35° C). Its winter is short, from December to February, and relatively mild, but the temperature can get down to 10° C.

(For more detailed information, please visit the website of Taiwan's Central Weather Bureau: www.cwb.gov.tw.)



- Electricity - Voltage
- 1. Voltage: 110 V
- 2. Frequency: 60 Hz
- 3. Plug (same as those used in the U.S.)

Two-hole socket



Three-prong outlet



- Currency - The currency used in Taiwan is the New Taiwan Dollar (NTD or NT). The exchange rate with the US dollar is 1: 29.1 (US dollar: NTD).

※Paper money comes in the following denominations: NT\$100, NT\$200, NT\$500, NT\$1000 and NT\$2000.

※Coin denominations include NT\$1, NT\$5, NT\$10 and NT\$50.

NTD2,000		NTD1,000	
NTD 500		NTD 200	
NTD 100		NTD 50	
NTD 10		NTD 5	
NTD 1			

2. Discovering Taiwan/ Pingtung

(1) Location: Taiwan lies on the western edge of the Pacific Ocean in an area known as the "rim of fire". It lies off the southeastern coast of Asia, across the Taiwan Strait from mainland China. To the north is Japan, and to the south is the Philippines. Many airlines fly to Taiwan, making it the perfect travel destination.

(2) Climate: Taiwan enjoys warm weather all year round. Weather conditions fluctuate during spring and winter, while in summer and autumn the weather is relatively stable. Taiwan is extremely suitable for traveling, as the annual average temperature is a comfortable 22 degrees Celsius (71.6 Fahrenheit) with the lowest temperatures on the lowlands generally ranging from 12 to 17 degrees Celsius (54-63 Fahrenheit). Except for a few mountain areas where some traces of snow can be found during winter, one rarely sees snow in Taiwan. During rainy season (March to May), continuously drizzling rain will sometimes fall on Taiwan.

(Please visit the following website for more details: <http://www.cwb.gov.tw>)

Month	Jan.	Feb.	Mar.	Apr.	May	Jun.	July	Aug.	Sep.	Oct.	Nov.	Dec.
Pingtung	19.3	20.3	22.6	25.4	27.5	28.5	29.2	28.7	28.1	26.7	24.0	20.6

① **Area:** 36,000 square kilometers

② **Population:** 23 million

③ **Capital:** Taipei City

④ **Time zone:** GMT +8 (no daylight savings)

⑤ **Language:** Mandarin Chinese (official language), Taiwanese, Hakka, and Indigenous languages

⑥ **Religion:** Taiwan is highly diversified in terms of religious belief, with the practices of Buddhism, Taoism, Christianity, Mormonism, the Unification Church, Islam, and Hinduism, as well as native sects such as Yiguandao and others.



3. Visa Information

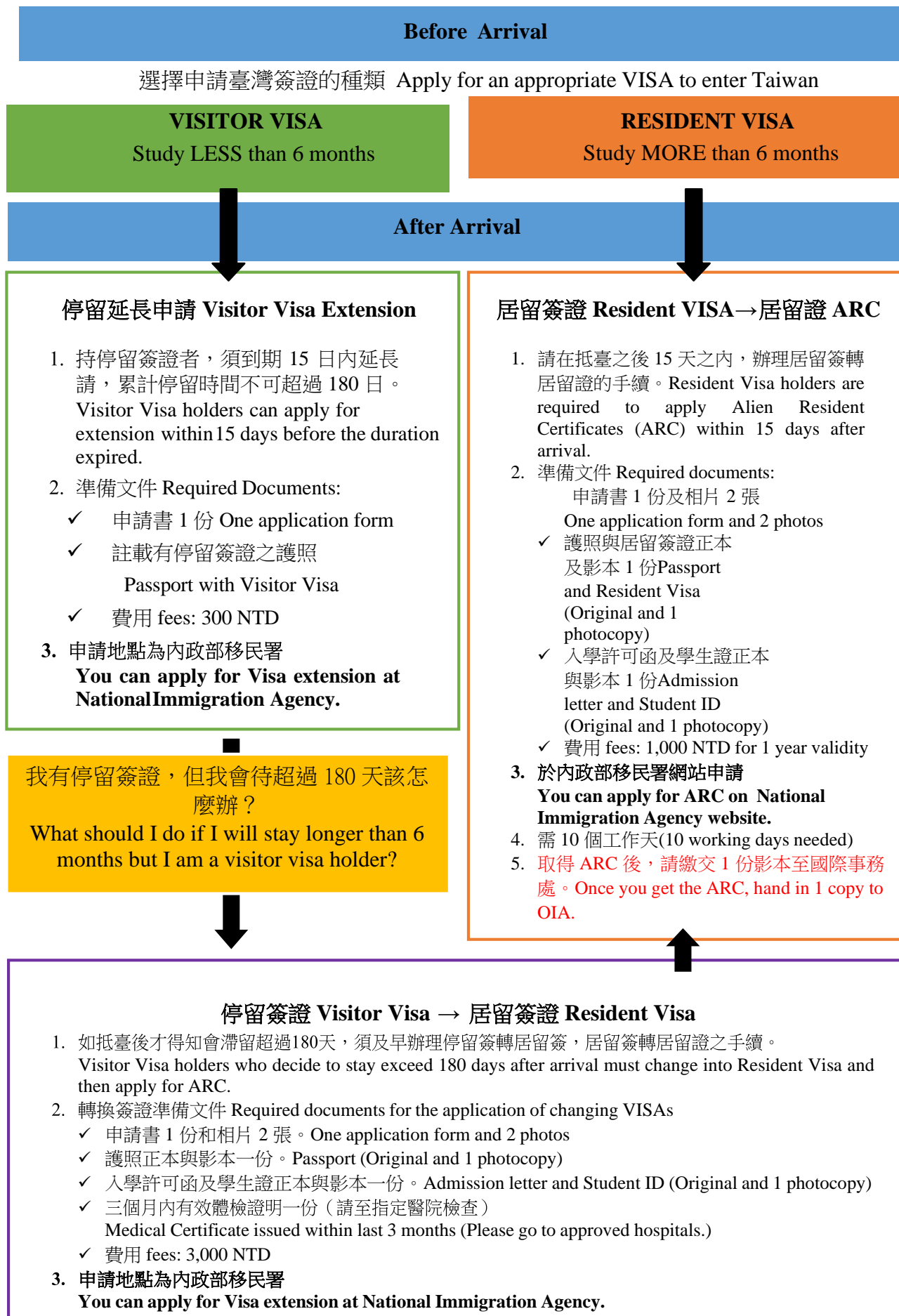

Arriving in Pingtung

1. Transportation

2. Accommodation

1. Transportation

NPTU is divided into Minsheng (民生) Campus, Pingshih (屏師) Campus and Pingshang (屏商) Campus, which both are located in Pingtung City.

Transportation is convenient. The distant to Pingtung station is about 3 kilometers.

✪ From Kaohsiung Xiaogang Airport to NPTU

1. By train:



- Take Kaohsiung MRT to Kaohsiung Train Station; get off the train at Pingtung station, and then take a taxi (or Pingtung bus) to NPTU (about 10 minutes).

(Taiwan railway website: https://tip.railway.gov.tw/tra-tip-web/tip?lang=EN_US)

2. By car:



- From Kaohsiung via the Gaoping Bridge, enter Pingtung City, go along Zi-Yo Road and then take Min-Sheng Road directly to school.
- From the No.3 Freeway, exit at the Lin-Lou Interchange, take the No.1 Provincial Highway and then Min-Sheng Road directly to school.

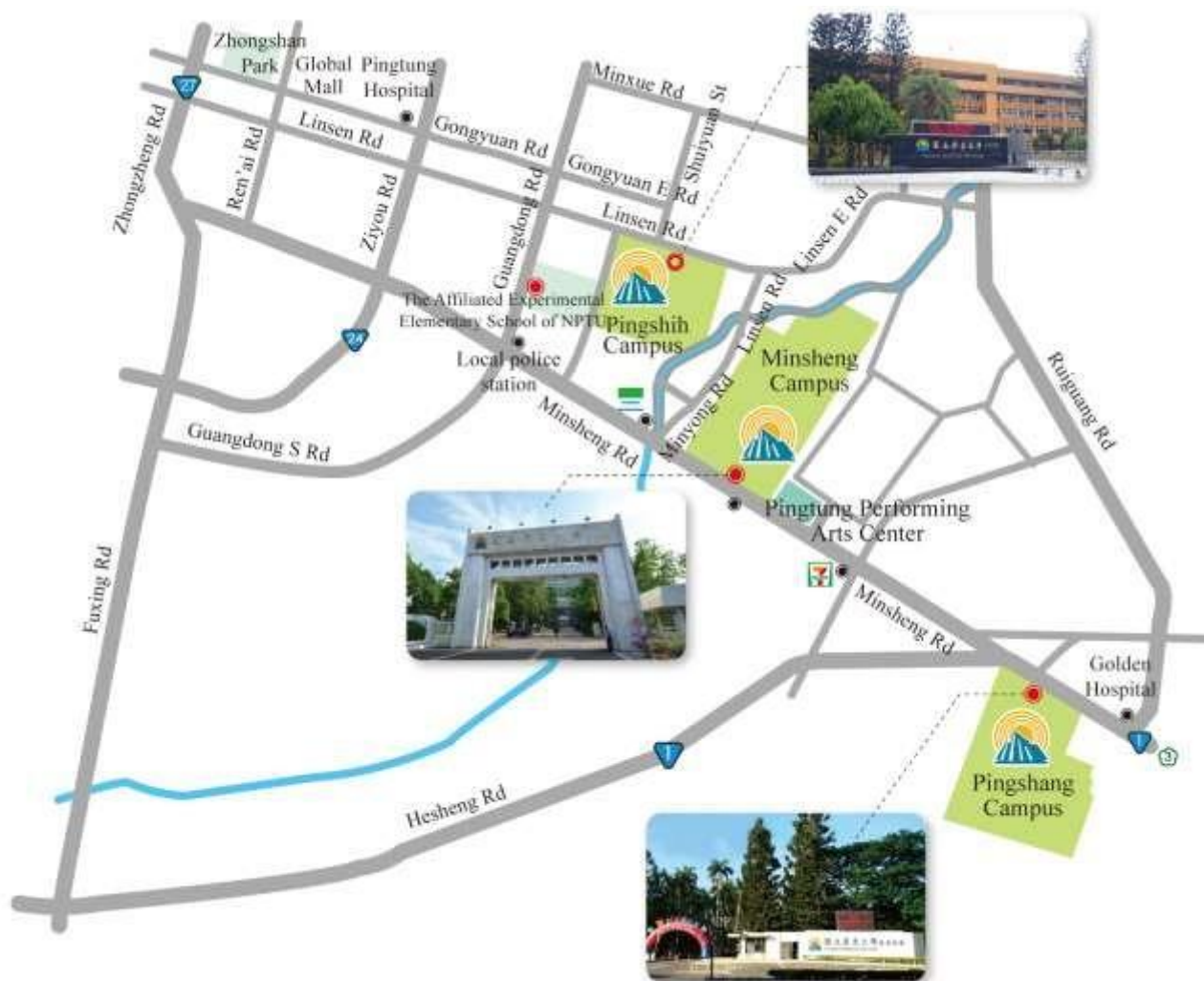

(Data Provider: Office of the Secretariat, General Affairs Division)

➡ From Taoyuan International Airport to NPTU

1. By Taiwan high speed rail:



- Take the shuttle bus to Taoyuan High Speed Rail Station; get off the high-speed rail at Zuoying Station, and transfer to the train for Pingtung Station. Take a taxi (or Pingtung bus) to NPTU (about 10 minutes).

2. By train:



- Take the shuttle bus to Taoyuan Train Station; get off the train at Pingtung station, and then take a taxi (or Pingtung bus) to NPTU (about 10 minutes).

Pbike

➤ About Pbike



The mass transportation of Pingtung City is mainly by means of Taiwan Railway and Highway Passenger Bus to Pingtung station. However, it is not the center of the majority of trips around the city. Therefore, to expand the public transportation services, the Pingtung City government had planned to adjust the routes of the city bus and combine them with the public bike rental system, providing railway and highway bus as the main way, city bus as the secondary way, and bike along with pedestrian as the final way of a public transit network service.

In view of this, in order to use bikes as the “last mile” transportation mode, we plan to build Pingtung City bike rental system, combined with other transfer transportations such as Taiwan Railway and Highway Passenger Bus, with different electronic tickets or credit cards. Besides satisfying daily transportation needs of Pingtung citizens, we also make all the efforts to turn bikes into a new tourist transportation when visiting Pingtung so as to make Pingtung a lower carbon city.

(source: http://pbike.pthg.gov.tw/About/aboutEn_01.aspx)

➤ Rental Steps

1 Rent with iPASS card

Rent on the kiosk

- Place the registered iPASS card on the sensor area on the kiosk.
- Select a bike dock number.
- Follow the instructions on the touch screen.
- Proceed to the chosen bike dock, and then retrieve the bike.

OR

Rent at the card reader on the dock

- Place the registered iPASS card at the sensor area of the card reader.
- Select a bike dock number.
- Press "OK" button.
- Proceed to the chosen bike dock, and then retrieve the bike.

2

Confirm the indicator light

- As the green indicator light starts blinking, please press the "Release" button.
- You can retrieve the bike after a beeping sound.



3

Pull the bike backwards

- Pull on the handlers backwards with both hands to retrieve the bike.

➤ Returning Steps

1

Select an empty parking space



- Select an empty parking space indicated by a red light.
- Aim the chip lock of the bike to the docking port.
- Aim the front wheel to the wheel holder on the ground.
- Gently push the bike in.

2

Confirm locking



- There will be two beeping sounds.
- The green light stays on.
- Shift the bike back lightly to make sure it is properly locked.



3 Return with the card

- Place iPASS card on the sensor area on the kiosk or at card reader on the bike dock.
- Confirm the rental fee paying successfully.
- The return process is completed.

(Resources form: <http://pbike.pthg.gov.tw/Station/TeachEn.aspx>)

2. Accommodation

(1) Dormitory

Our dormitory provides students with over 3,700 beds. These places have quite and beautiful environment, comfortable and safe. Our dorms ask the students to manage themselves, and they can get in the dorm with their own cards; besides, we also have 24 hours security service. There are cafeterias and student canteen in both males and females' dormitories, enable our students to have meals and buy what they need in the dorms. We also have cable televisions, community rooms, rooms for table tennis, studying, and discussions, and the vender machines, bath, drinking fountains as well. There are charged washing machines and tumble dryers on every floor of the dorms, and air conditioners on nearly every store, to make sure that our students can living and learning in a comfortable environment, that we can

change our students into qualified people of all aspects with the warm and harmonious living environment.



There are coin-operated washing machines, dryers, and public phones on floors. There is a public common room, a study room, an art room, and a table tennis room on the first floor of dormitory, for sake of leisure exercises for students. Other facilities include restaurants and a bookstore.



Our school is in Pingtung City, near the railway station (the distance from the station to our school is about 3 kilometers). Transportation is highly convenient. There are regular and frequent bus services between the school and the bus station (Scooters and bicycles are commonly preferable for students at NPTU).



National Pingtung University Student Dormitory Regulations

1. Please give the password of the door combination lock to the Service Center attendant on the first floor for any repair and maintenance issues.

School authorities can destroy the combination lock if the password isn't given to the attendant at the front desk on the first floor.

2. The dormitory public address (PA) system will only broadcast announcements from 12:00 to 12:30 and 19:00 to 20:00, although it can be used anytime in the event of an emergency.

3. Rules for using the dormitory bathroom:

- **Hot water is available from 17:30 to 24:00. Please turn off the water faucets and lights after use to conserve energy.**
- Please follow the instructions on the washing machines and dryers. Do not move the washers or dryers.
- Please maintain sanitary habits and have good manners when using the bathroom. Make sure the bathrooms are clean after use.

4. All students living in the dorm must obey the following rules; whoever violates any of these rules will be subject to penalties stipulated by NPTU regulations.

- Visiting hours: Weekdays 09:00~ 12:00 and 14:00~17:00; The dorms are not open to visitors on weekends and national holidays. Visitors must go to the Service Center on the first floor and leave their ID card there when registering. Visitors are prohibited from entering individual dorm rooms and are only permitted to use the lounge.
- Keeping pets of any kind, including dogs, cats, rabbits, birds, mice, snakes, etc., inside dorm rooms is strictly prohibited.
- Please take good care of the public facilities and lounge. Visitors caught vandalizing or damaging any public facilities will be required to pay for any necessary repairs.

➤ **The following behaviors are not allowed in the dorm rooms:**

1. Storing personal items in public areas of the dormitory (i.e., areas outside of the student dorm rooms).
 2. Drying clothes in areas not designated for clothes drying.
 3. Painting or carving the walls.
 4. Smoking, drinking, or gambling.
 5. Cooking.
 6. Other behaviors in violation of public health, peacefulness, and safety or than damage or endanger the environment.
- Manufacturing, transporting, selling, or hiding any dangerous objects or drugs, including fuel, arsenic, thallium, MDMA/ecstasy, amphetamines, etc., are strictly prohibited.
- The master lights of the dormitory building will automatically shut off from 12:00 am (midnight) to 06:00 in the morning. Only desk lamps and electrical outlets on the table will be available during these hours.
- The use of electric appliances and power strips without permission is strictly prohibited. Only hair dryers, radios, electric insect zappers, and computers are permitted to be plugged in to wall outlets.
- The voltage of the air conditioner outlets is 220V. Do not plug any other electrical device or those outlets or the devices could burn out.
- Posters, announcements, and circulars can only be put on the specified bulletin boards by permission. Putting them into the mailboxes is prohibited.
- Bicycles and motorcycles should be parked in designated student parking lots. Do not park bicycles and motorcycles around the dormitory or in dorm rooms.

A. Graduate Student Dormitory

Graduate Student Dormitory				
Campus	Building	Room type	Gender	Fee
Minsheng	4 th floor of Hsiaotung Building	Two beds with air conditioning	Female	NT\$ 13,030
Pingshi	1 st floor of Kuanghua Building	Three beds with air conditioning	Male	NT\$ 9,800
	2 nd floor of Kuanghua Building		Female	NT\$ 9,800



Hsiaotung Building



Kuanghua Building

B. College Student Dormitory

College Student Dormitory				
Campus	Building	Room type	Gender	Fee
Minsheng Campus	Building A、C	Four beds with air conditioning	Female	NT\$ 7,500
	5 th floor of Building A (503、504、507、512、514-516)	Four beds without air conditioning	Female	NT\$ 6,660
	Building E、F	Four beds with air conditioning	Female	NT\$ 7,500
	2 nd floor of Hsiaotung Building	Two beds with air conditioning	Female	NT\$ 13,030
	1st and 3rd floor of Hsiaotung Building	Four beds with air conditioning	Female	NT\$ 7,200
	Building B、D、	Four beds with air conditioning	Male	NT\$ 7,200

Pingshi Campus	Section A 1 st floor of Huilan Building	Four beds with air conditioning	Female	NT\$ 7,200
	Huilan Building	Four beds with air conditioning	Male	NT\$ 7,200
	Huilan Building	Four beds without air conditioning	Male	NT\$ 6,360
	Futang Building	Four beds with air conditioning	Male	NT\$ 7,800
Pingshang Campus	1 st dormitory	Four beds with air conditioning	Female	NT\$ 7,300
	2 nd dormitory	Four beds with air conditioning	Male/ Female	NT\$ 9,800

(Data Provider: Student Affairs Division, International Affairs Division)

(This announcement appears for information purposes only)

➤ Renting House

591 租屋	https://www.591.com.tw/home
好房網 HOUSE FUN	https://www.housefun.com.tw/
Airbnb	https://www.airbnb.com.tw/
Booking	https://www.booking.com/index.zh-tw.html
屏東安心學苑 Pingtung Ease Academy	https://www.facebook.com/www.pea.tw/
台糖椰林學苑	https://www.taisugar.com.tw/chinese/CP2.aspx?n=10329

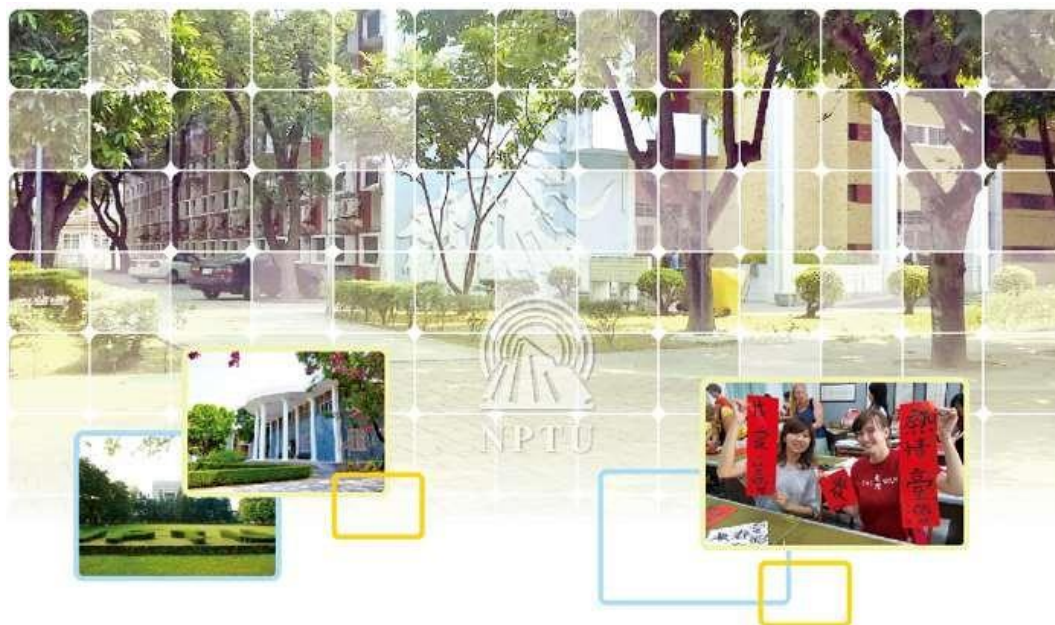

Introduction of NPTU

1. About NPTU

2. Goals

3. Campus Information

1. About NPTU

National Pingtung University (NPTU) is located in Pingtung County, which seat of the southernmost of Taiwan's 19 counties. With a population of over 900,000. Pingtung is a bustling marketing and industrial center. Pingtung County is one of Taiwan's major zones of agricultural production, yielding rice and other produce enjoyed throughout the island. Pingtung has a justified reputation as a lush and prosperous region.

NPTU was established by the merging of National Pingtung University of Education and the National Pingtung Institute of Commerce on August 1, 2014. After being merged, NPTU has become a mix of normal, managerial, computer science, technological, and higher education within one university in Pingtung County. There are 6 academic / teaching colleges in the university as follows:

- College of Management
- College of Computer Sciences
- College of Education
- College of Liberal Arts and Social Sciences
- College of Computer Science
- Innovative & International College

2. Goals

(1.) Developmental and Educational Goals

National Pingtung University (NPTU) was founded on August 1, 2014, upon the official merger of National Pingtung University of Education and National Pingtung Institute of Commerce. NPTU is a comprehensive university advocating academic freedom that emphasizes holistic learning and concern. Due to such recent changes in the educational environment as the focus on developing a more global outlook both on campus and in society, the decreasing birth rate, and a shortage of talent, NPTU aims to prepare students by providing them with practical and professional skills, as well as the reasoning and holistic qualities to function competently in a global environment.

In our quest for excellence, NPTU actively pursues global academic and research trends in order to develop and achieve success in various professional fields. NPTU strives to build upon its forerunner schools' excellent traditions in humanities, art, business, management, science and education by combining industry, academia, research and local resources to form a teaching and research university that is both comprehensive and professional. The mission of NPTU is to persistently strive for innovation and excellence, pursue national and international academic trends, and to combine industry and academia with Taiwan's natural and social resources in order to develop a university with wide-ranging features that include business, management, information, education, humanities, and arts, to cultivate students with a view of global citizenship suitable for meeting the needs of society. In addition, by combining vocational and technological training with teacher and other higher education, NPTU integrates primary

and secondary education, and promotes vocational and technological education along with higher education and to develop multilayered talent.

(2.) Vision

Diversification and confluence in preparing elite professionals who strive for excellence in their drive toward globalization

(3.) Mission

Pursue excellence and ensure quality education and equal learning opportunity while enhancing teaching, researching and learning resources in order to equip personnel with social values, build a sustainable and healthy environment, and dedicate ourselves to social progress.

3. Campus Information

NPTU is divided into 4 campuses; the Pingshi Campus is consisted of Colleges of Science, the Department of Music, Department of Visual Arts, a swimming pool and a student activity hall. The Minsheng Campus possesses the latest multi-administrative building, which is consisted of the administration and the library. The 14-story multi-administrative building is prosperously designed and multi-functional. There are also the latest auditorium and gymnasium at Minsheng Campus. College of Management and Library branch in Pingshang Campus. Moreover, three of them include beautiful park areas, athletic facilities, dormitories, classrooms. The fourth campus, Checheng Campus, is under construction.





民生校區
Minsheng Campus

屏商校區
Pingshang Campus





National Pingtung University Pingshih Campus Plane Configuration Diagram

- 
- | | |
|--|--|
| 1. 敬業樓
Jing Ye Building | 11. 六愛樓
Liu Ai Building |
| 2. 至善樓
Zhi Shan Building | 12. 思源樓
Shi Yuan Building |
| 3. 科藝館
Ke Yi Hall | 13. 惠蘭樓
Hui Lan Building |
| 4. 表演廳
Concert Hall | 14. 光華樓
Guang Hua Building |
| 5. 音樂館
Music Hall | 15. 懷旦樓
Hui Dan Building |
| 6. 校友之家
Alumni House | 16. 運動場
Stadium |
| 7. 科學館
Science Building I | 17. 球場
Courts |
| 8. 理學大樓
Science Building II | 18. 第一停車場
Parking Lot I |
| 9. 游泳池暨體適能館
Swimming & Fitness Centre | 19. 第二停車場
Parking Lot II |
| 10. 國際學院A棟
International Academy A | 20. 第三停車場
Parking Lot III |
| 10. 國際學院B棟
International Academy B | 21. 第四停車場
Parking Lot IV |
| 創新育成中心
Innovation & Incubation Center | 22. 機踏車停車場
Motorcycle & Bicycle Parking |
| 社區諮商中心
Community Counseling Center | 23. 校門口 & 警衛室
The Main Entrance & Guardroom |

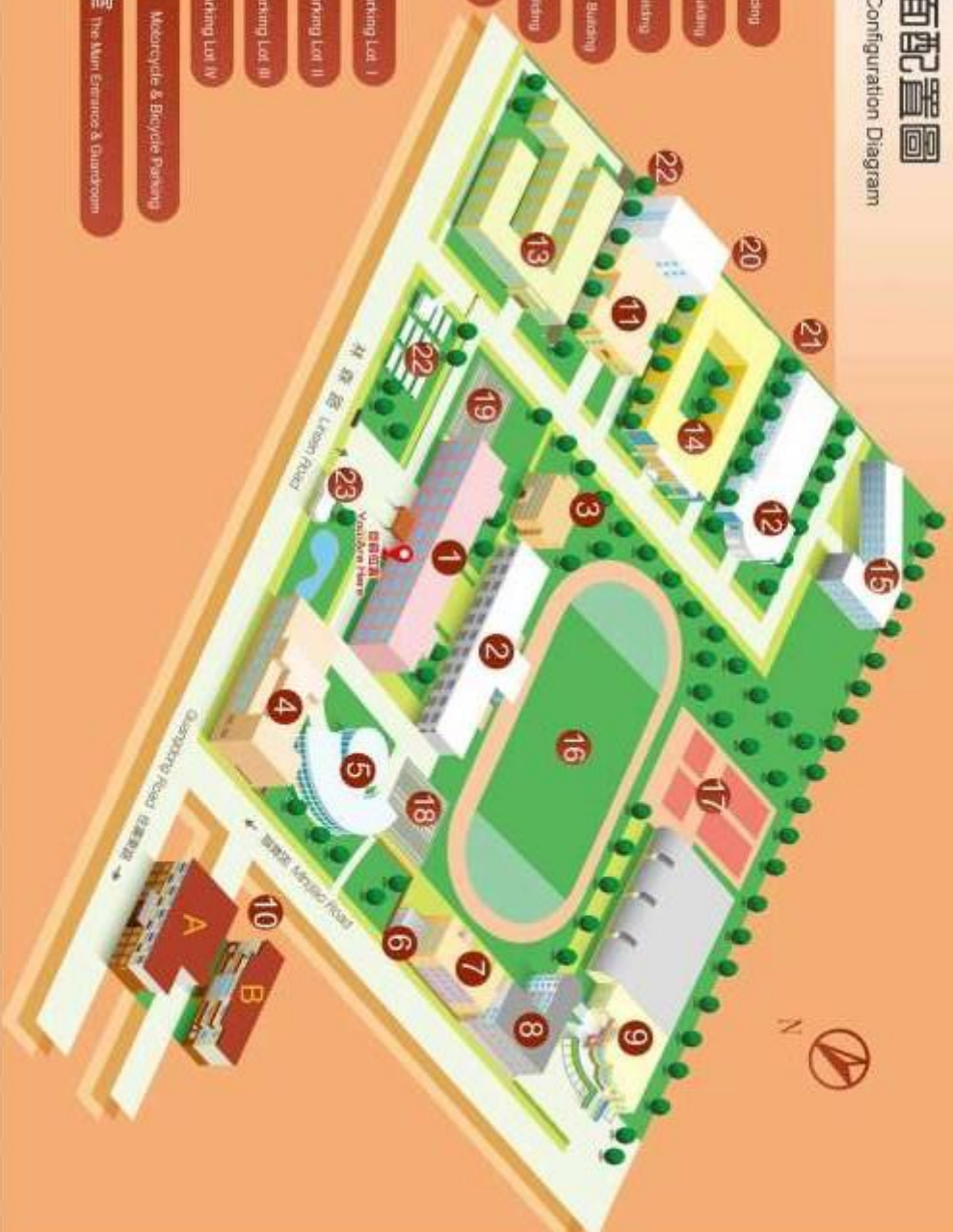

國立屏東大學屏師校區平面配置圖

National Pingtung University Pingshih Campus Plane Configuration Diagram

敬業樓 Jing Ye Building	
5F	教室-敬 501~敬 509 Classroom Ching 501~509
4F	教室-敬 401~敬 409 Classroom Ching 401~409
3F	教務處 Academic Affairs Divsion 副教務長室 Office of Associate Dean of Academic Affairs 專案業務組 Project Office 人文社會學院 College of Liberal Arts and Social Science 原住民族健康休閒與文化產業學士學位學程原住民專班 Studies of Health and Leisure & Cultural Industries for Indigenes B.A.Program 原住民族教育研究中心 Indigenous Education and Research Center 原住民族學生資源中心 Indigenous Student Resource Center 科普實驗媒體工作站 Science Communication X-media Lab. 簡報室 Briefing Room 教室-敬 307 Classroom Ching 307
2F	理學院院長室 College of Science 國際事務處 Office of International Affairs 華語教學中心 Chinese Language Center 語言教室 Language Lab 華語教室 2-1、2-2、2-3 Classroom Hua-yu 2-1 2-2 2-3 自學室 Self-learning Center 人文社會學院 College of Liberal Arts and Social Science 客家文化產業碩士學位學程 Master of Arts In Hakka Cultural Industry 電腦教室 敬 202 Computer Room Ching202
1F	教務處 Academic Affairs Divsion 推廣教育中心 Continuing Education Center 教學器材室 Teaching Equipment Room 動手做科學教育中心 Hands-On Science Leaning Center 文書交換室 Documents Interchange Room 教室-敬 102 ~ 104 Classroom Ching 102 ~ 104 哺乳室 Breastfeeding Room

至善樓 Zhi Shan Building	
2F	幼兒教育學系 Department of Early Childhood Education 幼兒照顧技術專業教室 Chlid Care Technology Classroom
1F	國際暨創新學院 Innovative & Internation Collage STEM 教育國際碩士學位學程 International Master Program of STEM Education 教育學系 Department of Education 學習產業研創中心 Practice-base for Learning Industry Entrepreneurship and

	Innovation Studies 南台灣實驗教室協作中心 South Taiwan Experimental Education Collaboration Center 永齡·鴻海台灣希望小學屏東分校 YongLin Hope School in Pingtung 原住民族課程發展協作南區中心 Indigenous Curriculum Development Collaborations Southern Center
--	---

科藝館 Ke Yi Hall	
5F	科學傳播學系 Department of Science Communication 主任辦公室 Chairman Office 科學數位化教學準備室 Digital Science Instruction 501 教室 Classroom 501 502 傳播與認知實驗室 Communication and Cognitive Laboratory 502 510 - 512 教師研究室 Faculty Office
4F	科學教育研究室 Research Office 401、402 教室 Classroom 411 - 415 教師研究室 Faculty Office
3F	301 油畫教室 Oil Painting Classroom 302 版畫教室 Printmaking Classroom 304 創意發想與實踐專用教室 Creative Thinking and Practice Classroom 311 研究室 Faculty Office 學生討論室 DSC Study Room
2F	201 視聽教室 Audio Classroom 202 人體素描教室 Life Drawing Classroom 203 材料學教室 Materials Classroom 204-205 研究生研究室 Graduate Student Research Room 204-205
1F	102 表演科技刻場 Performance & Technology Theater 視覺藝術學系 Department of Visual Arts 101 陶藝教室 Ceramics Classroom 103 裝置藝術教室 Installation Art Classroom 104 燒窯教室 Kiln Classroom

科學館 Science Building	
5F	501 演講廳 Auditorium 501 503 基礎物理實驗室(三) Laboratory (3) 503 物理儀器室(三) Physics Instrument Room (3) 光電材料暨元件實驗室 Photoelectrical Materials and Devices Laboratory
4F	403 基礎物理實驗室(一) Basic Physics Laboratory (1) 403 物理儀器室(一) Physics Instrument Room (1) 401 基礎物理實驗室(二) Basic Physics Laboratory (2) 401 物理儀器室(二) Physics Instrument Room (2) 401 402 404 教師研究室 Faculty Office 401 402 404

3F	應用化學系辦公室Office of Department of Applid Chemistry 第一會議室Meeting Room I 綠色光化學實驗室Green photochemistry Lab. 海洋資源開發實驗室Marine resource development Lab. 301-304 教師研究室Faculty Office 301-304
2F	201 203 實驗室 Laboratory 201,203 201-204 教師研究室 Faculty Office 201-204 第二會議室 Meeting Room II
1F	系學會辦公室 Student Association Office 101 103 實驗室 Laboratory 101,103 102 教室 Classroom 102 101 教師研究室 Laboratory 101

六愛樓 Liou Ai Building	
5F	運動產業研發中心 Sports Industry Research and Development Center 健康與體育學習領域教學研究中心 Health and Physical Education Teaching and Research Center 501-509 教師研究室 Faculty Office
4F	401 運動管理學實驗室 Sports Management Laboratory 402 運動生物力學實驗室 Sports Biomechanics Laboratory 403 體育系學會辦公室 Students Association Office 404 運動心理學實驗室 Sports Psychology Laboratory 405 運動休閒觀察復健室 Sports Leisure Observation & Rehabilitation Laboratory 406 運動生理學實驗室 Sports Physiology Laboratory 407 研究生討論室 Graduate Students Meeting Room
3F	體育系辦公室 Department of Physical Education Office 系圖書室 Department of Library 301 303 研究所教室 Graduate Students Classroom 302 會議室/教室 Conference Room / Classroom
2F	201 系學會辦公室 Student Association Office 202-213 視藝系教師研究室 Department of Visual Arts Teacher Laboratory 214 專題研討室 Seminar Classroom 215 動畫夢工廠 Animation Factory 216 數媒專題教室 Digital Media Seminar Classroom 217 視覺藝術學系系辦公室 Department of Visual Arts 218 會議室 Meeting Room 219 VR 教室 VR Classroom 220 遊戲夢工廠 Game Factor
1F	103 理論教室 Theory Classroom 104 理論教室 Theory Classroom 藝文中心 Arts Center



國立屏東大學

國立屏東大學屏東商校區平面配置圖

National Pingtung University Pingshang Campus Plane Configuration Diagram

- 1 目前位置
You/Here
- 2 校門口
The Main Entrance
- 3 警衛室
Security Room
- 4 第一汽車停車場
Parking Lot I
- 5 第三汽車停車場
Parking Lot II
- 6 第三汽車停車場
Parking Lot III
- 7 生態池
Ecological Pool
- 8 中央草坪
Central Lawn
- 9 機路車停車場
Motorcycle & Bicycle Parking
- 10 變電室
Transformer Room

- ### 行政區 Administrative Area
- 11 活動中心
Student Center
 - 12 行政大樓
Administration Building
 - 13 多功能資源中心
Multifunctional Resource Center

- ### 教學區 Teaching Area
- 14 教學資訊
Teaching & Resource Building I
 - 15 教學資訊
Teaching & Resource Building II
 - 16 圖資大樓
Library and Information Center Building

- 17 運動場
Stadium
- 18 球場
Courts

- ### 生活區 Living Area
- 19 綜合餐廳
Restaurant
 - 20 女生第一宿舍
Dormitory I
 - 21 女生第二宿舍
Dormitory II



國立屏東大學屏商校區平面配置圖

National Pingtung University Pingshang Campus Plane Configuration Diagram

圖資大樓 Library and Information Building	
12F	會議室 Conference Room
11F	應用英語系專業教室 Professional classroom(Department of Applied English)
10F	電腦教室(計中)、會議室 Computer Classroom, Conference Room
9F	電腦教室(計中) Computer Classroom
8F	計網中心辦公室、電腦教室(計中) Computer and Network Center, Computer Classroom
7F	圖書館-中西文書庫、日文書庫 Library-Chinese & Western Collections Japanese Collections
6F	圖書館-中文書庫 Library- Chinese Collections
5F	圖書館-流通服務臺、期刊區、數位多媒體區、證照用書/主要讀本區、辦公室 Library- Circulation Desk ,Current Periodicals, Digital Multimedia Area ,License/Certificate Exams Books Textbooks Area , Reference Collections ,Administration Office
4F	圖書館-閱覽室、討論室 Library- Reading Area Discussion Room
3F	語言學習區、圖書館閱覽區、檔案庫房 Language Learning Center, Library- Reading Area ,Archive
2F	圖書館-研究小間 Library- Individual Study Rooms
1F	國際會議廳 International Conference Hall
行政大樓 Administration Building	
5F	資訊管理學系 Office of Department of Information Management
4F	大武山學院-共同教育中心 Mt.Dawu College -Center for Common Core Education 博雅教育中心 Center for Liberal Arts Education 跨領域學程中心 Center for Interdisciplinary Studies , 應用英語學系 Department of Applied English 應用日語學系-日本文化中心 Department of Applied Japanese-Japanese Cultural Center Language Laboratory
3F	國際事務處 Office of International Affairs : 東南亞發展中心 Southeast Asian Development Center 國際學生組 International Student Affairs Section 國際合作組 International Collaboration Section 大陸事務組 Cross Strait Affairs Section 教育部專案辦公室 MOE Project Office 國際暨創新學院 Innovative and International College 實習就業輔導處-職涯發展與輔導組 Internship and Career Services Division-Section of Career Development and Service 管理學院 College of Management
2F	資訊學院 College of Computer Science 學生事務處 Student Affairs Division 學生諮商中心 Student Counseling Center 資源教室 Resource Room

	教務處 Academics Affairs Division 教學資源中心 Center for Teaching and Learning Resource
1F	收發室 Mail Room 總務處聯合辦公室 General Affairs Section 學生事務處 Student Affairs Division 生活輔導組 Guidance and Counseling Section 學生活動發展組 Student Activity Development Section 衛生保健組 Health Section 健康中心 Health Care Center 哺集乳室 Breastfeeding Room 教務處 Academics Affairs Division 進修教學組 Academic Affairs Section
教學壹館 Teaching and Resource Building I	
5F	行銷與流通管理學系 Department of Marketing and Distribution Management (S1504)
4F	財務金融學系 Department of Finance (S401) 不動產經營學系 Department of Real Estate Management (S402) 會計學系 Department of Accounting (S403)
3F	商業自動化與管理學系 Department of Commerce Automation and Management (S301)
2F	企業管理學系 Department of Business Administration (S1203)
1F	國際貿易學系 Department of International Trade (N1101)
教學貳館 Teaching and Resource Building II	
5F	教師研究室 Faculty Office (501~568)
4F	電腦與通訊學系 Department of Computer and Communication (M2414A) 資訊工程學系 Department of Computer Science and Information Engineering (S424A)
3F	休閒事業經營學系 Department of Leisure Management (E315) 教室 Classroom(M312~M314 N301~N304 S321~S324 W311)
2F	教務處聯合辦公室 Office of Academics Affairs (W211A) 教室 Classroom(M212~M214 N201~N204 S221~S224)
1F	階梯教室(紅廳) Lecture Theatre (Red Hall) (M2112) 階梯教室(藍廳) Lecture Theatre (Blue Hall) (M2111) 教室 Classroom(N101~N104 S121~S124)
B1	智慧機器人學系 Department of Intelligent Robotics(SB22A)



國立屏東大學民生校區平面配置圖

National Pingtung University Minshen Campus Plane Configuration Diagram



國立屏東大學民生校區平面配置圖

National Pingtung University Minsheng Campus Plane Configuration Diagram

教學科技館 Instructional Technology Building	
6F	天象館 Planetarium
5F	教室(機器人學士學位學程 Computer and Intelligent Robot)
4F	辦公室 Office (機器人學士學位學程 Computer and Intelligent Robot、資訊科學系 Department & Graduate School of Computer)、教室 classroom
3F	教室(機器人學士學位學程 Computer and Intelligent Robot) 辦公室(文化創意產業學系 Cultural and Creative Industries) 黑色布幕劇場 Theater of Black Curtain
2F	辦公室(文化創意產業學系 Cultural and Creative Industries) 辦公室(教學資源中心 Center for Teaching and Learning Resource)
1F	會議室 Conference Room、貴賓室 VIP lounge

人文館 Humanities Building	
5F	教師研究室 Office of Research on Teachers
4F	教室 classroom (中國語文學系 Department of Chinese and Literature)
3F	教室 classroom (英語學系 Department of English)
2F	辦公室 classroom (中國語文學系 Department of Chinese and Literature、英語學系 Department of English)
1F	教室 classroom (中國語文學系 Department of Chinese and Literature、英語學系 Department of English)
BF	教室 classroom (中國語文學系 Department of Chinese and Literature)

體育館 Gymnasium	
3F	綜合球場 Comprehensive Stadium、社團辦公室 student association office
2F	社團辦公室 student association office
1F	體操教室 Gymnastics classroom、舞蹈教室 Dance classroom

禮堂 Auditorium	
2F	禮堂 Auditorium
1F	禮堂 Auditorium、貴賓接待室 VIP lounge、儲藏室 Storage

國立屏東大學民生校區平面配置圖
National Pingtung University Minsheng Campus Plane Configuration Diagram

學生宿舍及餐廳 Student dormitory & Restaurant	
2F	學生寢室 Student dormitory、社團辦公室 Community Office
1F	餐廳 Restaurant、宿舍管理室 Dormitory Management Office、讀書室 Reading Room

小東樓 Xiaodong Building	
1F	宿舍管理室 Dormitory Management Office、學生寢室 Student dormitory

五育樓 Wu Yu Building	
11F~14F	教師研究室 Office of Research on Teachers
10F	特殊教育學系 Department of Special Education、諮商中心學校諮商組 Counseling Center School Counseling Section、特教中心 Special Education Center、教育學系 Department of Education、教育學院 College of Education、人文社會學院 College of Liberal Arts and Social Sciences、師資培育中心 Center of Teacher Education
6-9F	圖書館 Library
5F	社會發展學系 Department of Social Development、文化創意產業學系 Department of Cultural and Creative Industries、教育學系 Department of Education、教育心理與輔導學系 Department of Educational Psychology and Counseling
4F	人事室 Personnel Office、應用數學系 Department of Applied Mathematics、通識教育中心 General Education Center、幼兒教育學系 Department of Early Childhood Education、教育行政研究所 Graduate Institute of Educational Administration、會議室 Conference Room、國際會議廳 International Conference Hall
3F	校長室 Office of the President、秘書室 Office of the Secretariat、主計室 Office of Accounting、副校長室 Office of the Vice President、研究發展處 Research and Development Division
2F	教務處 Academic Affairs Division、學生事務處 Student Affairs Division
1F	總務處 General Affairs Division、衛生保健組 Health Section
BF1	計網中心 Computer and Network Center、資訊科學系 Department & Graduate School of Computer 技能檢定試務中心 Skills Check Service Center、電腦教室 Computer Classroom
BF2	停車場 Parking lot

Life

1. *Individual Account Application
for Post Office or Bank*
2. *Healthcare and Insurance*
3. *Hospitals and Clinics*
4. *Exchanging for Domestic Driving License*
5. *Life in NPTU*

1. Individual Account Application for Post Office or Bank required documents for opening an account:

- (1) Passport
- (2) ARC
- (3) Personal seal

Chunghwa Post Office

- No.61-7 Minsheng Rd. Pingtung Country , Pingtung City (Nearby Minsheng Campus)
- No.30-5 Linsen Rd. Pingtung Country , Pingtung City (Nearby Pingshih Campus)

2. Healthcare and Insurance

(1) Medical Check

All freshmen should participate in the physical examination program and the examination will be conducted at the beginning of each new semester. If the medical exam has already been conducted abroad, a copy of the medical exam report needs to be submitted to the health center.

NPTU physical examinations check post:

NPTU will conduct physical examinations for students in the first week of the Fall semester (in September) in the school gym.

Items Requested for Health Certificate:

Students need to fill out the checklist for medical examinations to apply for the Taiwan resident visa. For more information, please refer to the following link:

<https://www.immigration.gov.tw/lp.asp?ctNode=30085&CtUnit=16740&BaseDSD=111&mp=2>

(2) Health Insurance

Student Accident Insurance (Optional)

Student insurance costs NT\$500 per month. Once covered under the plan, you may receive compensation if you are hospitalized, use outpatient services, or undergo an operation in the event of illness or accidental injury. Compensation must be claimed within two years of the accident or illness. To claim compensation, please go to Student Affairs Division.

National Health Insurance (NHI)

- Due to the regulation of NHI, only those who have already stayed in Taiwan for more than 6 months are eligible to join the NHI plan.

- Benefits of NHI:

You will be issued a Student NHI IC Card after you join the program. Your NHI IC card, along with Alien Resident Certificate, will allow you to seek covered medical services from NHI-affiliated hospitals and clinics. To avoid wasting of medical resources, you are responsible for the medical facility registration fee as well as other supplementary fees.

External link:

1. National Health Insurance Administration: <https://www.nhi.gov.tw/english/>
2. Ministry of Education: <http://www.moe.gov.tw/>

Documents required to apply for the NHI program

- Application form
- A copy of your resident visa and student ID card
- 2 photographs (3.5x4.5cm)
- Fees: NT\$200
- Application Division: National Health Insurance Administration

3. Hospitals and Clinics

※ Major medical institutes in Pingtung city

(1) Golden Hospital 國仁醫院 (guó rén yī yuàn)

- Telephone: +886-8-722-3000
- Address: No.12-2, Minsheng E. Rd., Pingtung City
- Website: <http://www.golden-hospital.com.tw>

(2) Ministry of Health and Welfare Pingtung Hospital 衛生福利部屏東醫院 (píng dōng yī yuàn)

- Telephone: +886-8-736-3011
- Address: No.270, Ziyou Rd., Pingtung City
- Website: <http://www.pntn.mohw.gov.tw/>

(3) Paochien Hospital 寶建醫院 (bǎo jiàn yī yuàn)

- Telephone: +886-8-733-5987
- Address: No.123, Chung Shan Rd., PingTung City
- Website: <http://www.paochien.com.tw/twuse>

(4) Pingtung Christian Hospital 屏東基督教醫院 (píng dōng jī dū jiào yī yuàn)

- Telephone: +886-8-736-8686
- Address: No.60, Dalian Rd., Pingtung City
- Website: <http://www.ptch.org.tw/>

※ Privileged hospitals with NPTU

- Some clinics and hospitals in Pingtung city signed a contract with NPTU. Our students can get the discount in those privileged hospitals or clinics.
- Link: <https://staf-health.nptu.edu.tw/var/file/75/1075/img/2226/771836230.jpg>

※The school hospital of National Pingtung University

The service hours at **12:30 p.m to 13:30 p.m.**

week	Monday	Tuesday	Wednesday	Thursday	Friday
1st Floor of Wu-Yu Building at Minsheng Campus	*		*		*
1st Floor of Administration Building at Pingshang Campus		*		*	

4. Exchanging for Domestic Driving License

Required documents:

- (1) Identity documents (original and photocopy):
- (2) Nationals with nationality of R.O.C. and have household registration in the Taiwan area should submit national I.D. card or military I.D. card.
 - ※ For those who hold formal driving licenses issued by foreign government, Mainland China area, Hong Kong or Macau and obtain staying permit or residence permit for more than 6 months, they can submit the application the next day after entry.
- (3) Three one-inch color photos with glossy single-color background, without wearing hat, with clear facial features, bust shot, and were taken within past 2 years. Do not use image synthesis.
- (4) Original passport and its photocopy.
- (5) Original overseas driving license within the expiration and its photocopy (verification application required).
- (6) Automobile (motorcycle) driving license registration form with qualified health examination.
- (7) Proof of entry/exit record.
- (8) Driving license fee: NT\$200

Notice:

If the driving license is in a foreign language except English, **a copy of translation in Chinese** shall be provided and it must be verified by our embassy, representative office, the office or by domestic public notary.

Driving licenses issued in **Mainland China area** shall be verified by the institutions established or appointed by Executive Yuan or private groups entrusted. After passing written exam, people from Mainland China could apply for the driving license in our country.

Driving licenses issued in **Hong Kong or Macau** should be verified by the institutions established or appointed in Hong Kong or Macau by Executive Yuan or private groups entrusted.

Driving licenses issued by other countries or regions shall be verified by our embassies, representative offices, offices, or other institutions authorized by Ministry of Foreign Affairs, or foreign institutions in Taiwan that are authorized by foreign embassies in Taiwan, foreign governments or regions and agreed by Ministry of Foreign Affairs in our country for handling the business of document verification.

According to the official letter from Ministry of Transportation and Communications, the principles of handling the exchange of motorcycle driving licenses issued by the governments in our reciprocal countries for the motorcycle driving license in our country are “if the driving license issuing country does not handle it according to the level of engine displacement or horsepower, it can be exchanged to the general heavy motorcycle driving license in our country based on the above regulations. If a driving training certificate on large heavy motorcycle for more than 32 hours but less than 43 hours is provided, a driving license for large heavy motorcycle with a cubic capacity not exceeding 550 cm³ will be issued. However, a driving license for large heavy motorcycle with a cubic capacity exceeding 550 cm³ will be issued if a driving training certificate on large heavy motorcycle for more than 43 hours is provided.

5. Life in NPTU

POYA

Cosmetic, beauty and skin care products, living necessities, hardware supplies, snack foods, and socks, etc.

Address: No.248, Minsheng Rd., Pingtung City

Tel: +886-8-765-5500

Operation hours: 10:00-22:30

Website: <http://www.poya.com.tw/>

Food

Pingtung Food Map:

<https://goo.gl/peJLCz>

Travel

Pingtung Bus

Tel: +886-8-723-7131

Webiste: <http://www.ptbus.com.tw/>

Pbike

Purchase iPassCard from any convenience store. Location map:

<http://pbike.pthg.gov.tw/Station/MapEn.aspx>

Pbike Service Center

Pingtung county government lobby, No.527, Ziyou Rd., Pingtung City, Pingtung County

Tel: 0800-255900

Taiwan Railways (Pingtung Station)

Tel: +886-8-751-5140 (Pingtung)

Website: <https://www.railway.gov.tw/tra-tip-web/tip>

Taiwan High Speed Rail

Tel: International Calls: +886-2-4066-3000 Local 4066-3000

Website: <https://en.thsrc.com.tw/>

Post Office

Address: No.61-7 Minsheng Rd. Pingtung Country , Pingtung City (Minsheng Campus nearest)

No.30-5 Linsen Rd. Pingtung Country , Pingtung City (Pingshih Campus nearest)

Services: Postalservices and banking services

Tel: Postal services +886-8-7323-310, banking services +886-8-7330-222

Website: http://www.post.gov.tw/post/internet/U_english/

Opening a savings account:

http://www.post.gov.tw/post/internet/U_english/index.jsp?ID=24030101

※ Service for International withdrawal isn't provided at post office. If you want to withdraw money from international banks, please go to 7-11 convenience stores around the school.

Daily Commodity

Watsons

- Cosmetics, skin care products, hair products, health care products, and daily implements

- Address:

1. No.43, Minsheng Rd., Pingtung City, Pingtung County
2. No.23-3, Pingshi Rd., Pingtung City, Pingtung County

PX Mart

- Supermarket, groceries and household products

- Address: No.6, Ruimin Rd., Pingtung City, Pingtung County

Carrefour

- Department store, groceries and household products

- Address: No.188, Ren'ai Rd., Pingtung City, Pingtung County

- Tel: +886-8-738-0310

- Operation hour: Mon.-Sun.: 9:00-23:00

Appendix

- 1. Emergency Contact Numbers*
- 2. Highlight Attractions in Greater
Pingtung Area*

1. Emergency Contact Numbers



國立屏東大學 校園安全專線
THE DIRECT / SERVICE LINE OF NPTU MILITARY
EDUCATION AND CAMPUS SECURITY REPORT CENTER

民生、林森校區校安專線
Minsheng, Linsen Campus **0912-838499**

屏商校區校安專線
Pingshang Campus **0965-389995**

上述電話為發生意外事故或校園安全事件時撥打 服務專線請留給需要的人
For emergencies or campus safety issues only Please save the line for people in need

學生申訴(含性平事件) 受理窗口 學生事務處
Student Appeals(Include gender issues) point of contact student affairs

專線 TEL **08-7663800** 轉 EXT. **12000**
TEL **08-7663800** EXT. **12001**

國立屏東大學
National Pingtung University

2. Highlight Attractions in Greater Pingtung Area

Recommended Tourist Spots

by Tourism Bureau, Republic of China (Taiwan)

Website:

<https://eng.taiwan.net.tw/>

Youth Travel in Taiwan

by Youth Development Administration, Ministry of Education

<https://youthtravel.tw/>

Wish you success in your studies and hope that your experiences at NPTU will be fulfilling and memorable!

